

## LED600SICA / LED600SICA-01V

6" IC Air-Tight LED Dedicated Sallow New construction Housing

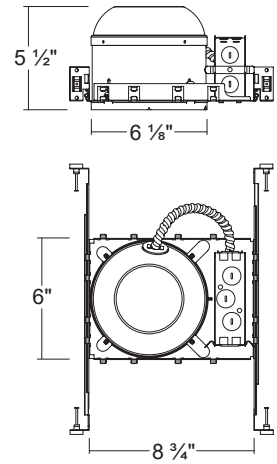

### Dimensions



## SPECIFICATION

### Plaster Frame

- Galvanized steel construction. The housing can be removed from plaster frame to provide access to the junction box

### Junction Box

- Listed for through branch circuit wiring
- Contains seven 7/8" knockouts and four Romex pryouts with strain relief

### Bar Hanger

- Pre-installed Real nail easily installs in regular lumber, engineered lumber
- Bar Hangers are adjustable from 13-5/8" to 25" and can be repositioned 90 degree on plaster frame

### Listings

- cULus Listed for Damp Location
- cULus Listed for Feed Through
- Certified under ASTM-E283 for Air tight construction

## CONNECTOR

**LED600SICA**  
Triac Dimming Ver.

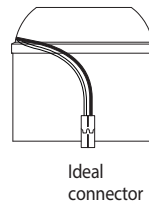

Ideal  
connector

**LED600SICA-01V**  
0-10V Dimming Ver.

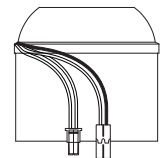

Molex  
connector      Ideal  
connector

## ORDERING INFORMATION

Model No.	Dimming	Description
LED600SICA	Triac Dimming	6" IC Air-Tight Dedicated Shallow New construction Housing
LED600SICA-01V	0-10V Dimming	6" IC Air-Tight Dedicated Shallow New construction Housing

## COMPATIBLE TRIMS

LED600SICA Model NO.	Description
LRKT56X Series	5&6 inch LED All Retrofit kit Series
LRKT64X Series	6 inch LED Square Retrofit kit Series
LRKT56X-3CCT Series	5&6 inch Selectable 3 CCT LED All Retrofit kit Series
LRKT64X-3CCT Series	6 inch Selectable 3 CCT LED Square Retrofit kit Series
LRKT56X-5CCT Series	5&6 inch Selectable 5 CCT LED All Retrofit kit Series
LRKT64X-5CCT Series	6 inch Selectable 5 CCT LED Square Retrofit kit Series

LED600SICA-01V Model NO.	Description
LRKT56X-5CCT-M Series	5&6 inch Selectable 5 CCT LED All Retrofit kit Series
LRKT64X-5CCT-M Series	6 inch Selectable 5 CCT LED Square Retrofit kit Series